

**Philcon '92**

**Pocket**

**Program**

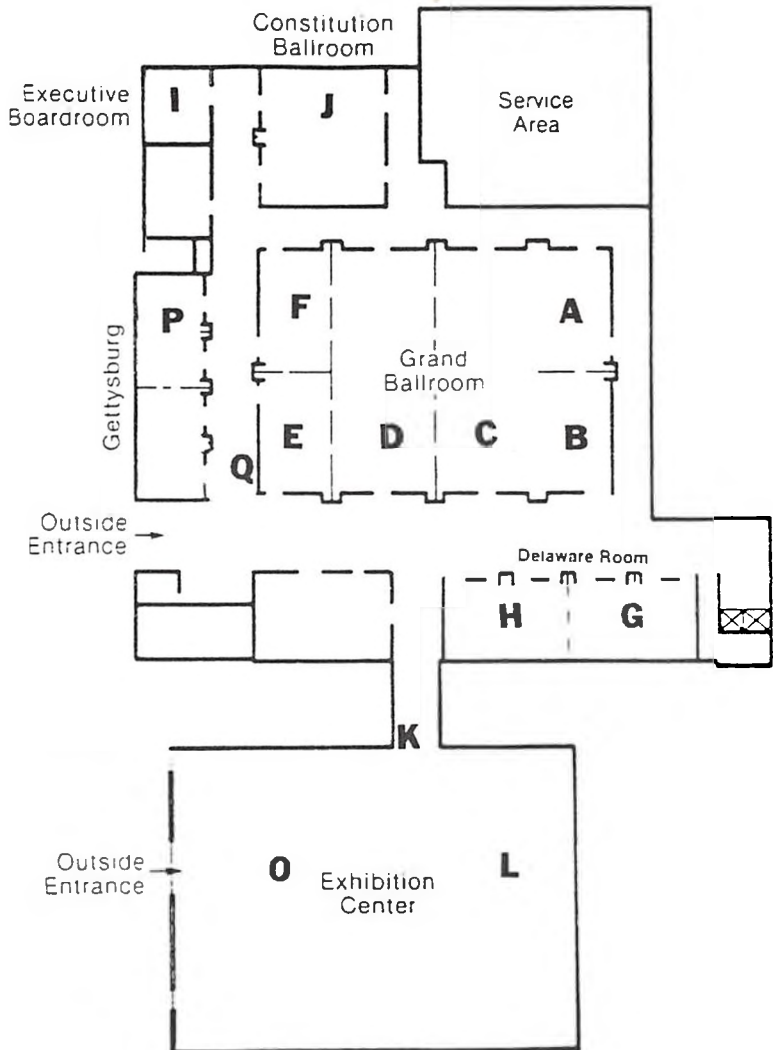

|                         |          |                              |          |
|-------------------------|----------|------------------------------|----------|
| <b>Grand Ballroom A</b> | <b>A</b> | <b>Executive Boardroom</b>   | <b>I</b> |
| <b>Grand Ballroom B</b> | <b>B</b> | <b>Constitution Ballroom</b> | <b>J</b> |
| <b>Grand Ballroom C</b> | <b>C</b> | <b>Exhibition Center</b>     |          |
| <b>Grand Ballroom D</b> | <b>D</b> | <b>Hallway-Autographs</b>    | <b>K</b> |
| <b>Grand Ballroom E</b> | <b>E</b> | <b>Hall-Art Show</b>         | <b>L</b> |
| <b>Grand Ballroom F</b> | <b>F</b> | <b>Hall-Dealers Room</b>     | <b>O</b> |
| <b>Delaware 1&amp;2</b> | <b>G</b> | <b>Gettysburg 3&amp;4</b>    | <b>P</b> |
| <b>Delaware 3&amp;4</b> | <b>H</b> | <b>Marker Suite 2301</b>     | <b>N</b> |

## **Weapons policy**

No weapons — guns, gun replicas, swords, knives, lasers, model lasers, or anything that the public could perceive as a weapon — will be permitted at Philcon. The Philcon Committee has the final say as to what constitutes a weapon. Unfortunately, we must reserve the right to revoke the membership of anyone who refuses to comply with this policy.

The only exception to this policy is as follows: registered participants in the Masquerade may wear a weapon, excepting operational guns and lasers, from one half-hour before the Masquerade to one half-hour after it.

## **A word on costumes:**

Please remember that No Costume is No Costume. Legal requirements concerning the minimum coverage of certain body parts should be observed. G-strings, thongs, and pasties, by themselves or in combination, are not sufficient.

| FRIDAY   |  |  |  |
|----------|--|--|--|
|          | 6 PM   | 7 PM   | 8 PM   |
| <b>D</b> |  | <b>How Fans Get Together</b><br><i>Bushyager (m), Schwartz, Axler,<br/>Baldonis, Bacon-Smith,<br/>Fleishmann</i>             | <b>PSFS Meeting:</b><br><i>Pamela Sargent</i>  |
| <b>E</b> |  | <b>Women &amp; Fantasy</b><br><i>Gostkysan, Van Vlack, Cramer,<br/>Homgsberg (m), Holman,<br/>bes shahar, Hamwell, Bugge</i> | <b>Classic Fantasy</b><br><i>Schwitzer (m), Kondratiev, Bear,<br/>Suthers</i>                                |
| <b>F</b> |  | <b>Bookaholics<br/>Anonymous</b><br><i>Logue (m), Noron, Dashoff,<br/>bes shahar, Fontecchio, Bisenieks</i>                  | <b>Influence of Film on<br/>Writing</b><br><i>Beancourt, Morrow, Harris (m),<br/>Weinstein, Krulik, Mist</i> |
| <b>G</b> | <b>New Games</b><br><i>D. Homgsberg</i>  | <b>Introduction to Masquerading</b>  |  |
| <b>H</b> | <b>Alternate Art Markets</b><br><i>Wyman (m), Koszowski,<br/>Dougherty, Menthan, Varanoff,<br/>McClellan</i> | <b>The Horror of It All</b><br><i>Bauman (m), Clarke, Eggleton,<br/>Koszowski, Lang</i>                                      | <b>It's What's Inside</b><br><i>Walters (m), Blanchard, Junsching,<br/>Hinge, Lake</i>                       |
| <b>I</b> | <b>Reading</b><br><i>Susan Casper</i>  | <b>Reading</b><br><i>John DeChance</i>   |  |
| <b>J</b> | <b>Chronic Rift</b><br><i>featuring Asimov retrospective</i>   | <b>The Legend of Hell House</b>  |  |
| <b>K</b> | <b>Autograph Signing</b>   | <b>Autograph Signing</b>   | <b>Autograph Signing</b>   |
| <b>L</b> | <b>Art Show open</b>   |  |  |
| <b>M</b> | <b>Babysitting open</b>  |  |  |
| <b>N</b> | <b>Con Suite closed</b>  |  | <b>Con Suite open</b>  |
| <b>O</b> | <b>Dealers Room open</b>   |  | <b>Dealers Room closed</b>   |
| <b>P</b> | <b>Gaming open</b>   |  |  |
| <b>Q</b> | <b>Post Office closed</b>  |  |  |

**FRIDAY**

|          | <b>9 PM</b>  | <b>10 PM</b>   | <b>11 PM - 3 AM</b>                          |
|----------|--|--|--|
| <b>D</b> | <b>Meet the Pros</b><br><i>(begins at 9:30)</i>  | <b>Dance</b><br><i>(begins at 10:30)</i>   |  |
| <b>E</b> | <b>Goldfish Don't Vote</b><br><i>Andrews, Norman, Sargent,<br/>Friesner, Cramer, MacBride Allen,<br/>Kagan, Chase, Ore</i> |  |  |
| <b>F</b> |  |  |  |
| <b>G</b> | <b>Planning Filk for Your Convention</b><br><i>Hugel (m)</i>   |  | <b>Filking</b>                               |
| <b>H</b> |  |  | <b>Filking</b>                               |
| <b>I</b> |  |  |  |
| <b>J</b> | <b>Bubblegum Crisis</b><br><i>episode 1 (subtitled)</i>  | <b>Bloodsucking Pharaohs in Pittsburgh</b><br><i>Kaye (m), Penberthy, Hamilton</i> | <b>Nosferatu</b><br><i>(starts at 12:30)</i> |
| <b>K</b> |  |  |  |
| <b>L</b> | <b>Art Show closed</b>   |  |  |
| <b>M</b> | <b>Babysitting open</b>  |  | <b>Babysitting</b> <i>(closes Midnight)</i>  |
| <b>N</b> | <b>Con Suite open</b>  |  |  |
| <b>O</b> | <b>Dealers Room closed</b>   |  |  |
| <b>P</b> | <b>Gaming open</b>   |  |  |
| <b>Q</b> | <b>Post Office closed</b>  |  |  |

| <b>SATURDAY</b> |  |   |   |
|-----------------|--|---|---|
|                 | <b>9 AM</b>  | <b>10 AM</b>  | <b>11 AM</b>  |
| <b>D</b>        |  | <b>Contact</b><br><i>Bear Barr (m), Walters, K. Kojed, Barlow</i>                                       | <b>Cult Authors</b><br><i>Cholfin (m), Kaye, Schweitzer, Krulik, Bisson</i>                                     |
| <b>E</b>        |  | <b>Arthurian Mythos</b><br><i>Kondrakov (m), Friesner, A. Homigsberg, bes shahar, Harris, Schneck</i>   | <b>Speaker to Aliens</b><br><i>Axler, Beason, Von Gunden, Asher (m), Kagan, Gilliland</i>                       |
| <b>F</b>        | <b>Slideshow</b><br><i>J.K. Klein</i>  | <b>Mainstream SF and F</b><br><i>Zebrowski, Moffet, van Gelder (m), Lewitt, Troy-Casiri, Frost, Ore</i> | <b>Changing Face of Science Fiction</b><br><i>Bacon-Smith (m), Norman, Kotani, Garland, Drew, Doherty</i>       |
| <b>G</b>        |  | <b>Costume Headpieces</b><br><i>Mayberry</i>  | <b>Nanotechnology</b><br><i>Andrews</i>   |
| <b>H</b>        |  | <b>3D SF and Fantasy Art</b><br><i>K. Kojed (m), Frechene, Sorren, Harryhausen, Kushwara</i>            | <b>When Dinosaurs Ruled the Arts</b><br><i>Walters (m), Brett-Surman, Chapman, Harryhausen, Schultz, Sorren</i> |
| <b>I</b>        | <b>Clarion Workshop Panel</b><br><i>O'Connor (m), Krans, Zender, Savage, Seelhammer, Maranko</i> | <b>Self-Promotion for Writers</b><br><i>Clough, Sargent, Van Vlack, J. Beaucaourt (m), Pollona, Tan</i> | <b>Editors</b><br><i>Seithers, Williams (m), J. Beaucaourt, Strock, Dozos, Ryan, Edelman</i>                    |
| <b>J</b>        | <b>Phase IV</b>  |   | <b>Bubblegum Crash</b><br><i>episode 1: "Illegal Army" (submitted)</i>  |
| <b>K</b>        |  | <b>Autograph Signing</b>  | <b>Autograph Signing</b>  |
| <b>L</b>        | <b>Art Show closed</b>   | <b>Art Show open</b>  |   |
| <b>M</b>        | <b>Babysitting open</b>  |   |   |
| <b>N</b>        | <b>Con Suite closed</b>  |   | <b>Con Suite open</b>   |
| <b>O</b>        | <b>Dealers Room closed</b>   | <b>Dealers Room open</b>  |   |
| <b>P</b>        | <b>Gaming open</b>   |   |   |
| <b>Q</b>        | <b>Post Office closed</b>  | <b>Post Office open</b>   |   |

**SATURDAY**

|          | <b>NOON</b>  | <b>1 PM</b>  | <b>2 PM</b>  |
|----------|--|--|--|
| <b>D</b> | <b>A Dialogue:<br/>Greg Bear &amp;<br/>Ray Harryhausen</b>   | <b>I Wanna be a Galactic<br/>Overlord...</b><br><i>Bear, Morrow, Gale, Lyon, Park,<br/>D. Hongberg, Andrews (m), Ore</i>                         |  |
| <b>E</b> | <b>Suppose Queen<br/>Isabella HAD Said No</b><br><i>Morrow, Rothman (m),<br/>Bredenberg, Andrews, Swanwick</i> | <b>Worst Foot Forward</b><br><i>Sargen (m), Asher, DeChance,<br/>Frost, Hams, Kowani, Moffet,<br/>Pollara, bes shahar, Anderson,<br/>Chalker</i> |  |
| <b>F</b> | <b>Horror Fiction</b><br><i>van Gelder, Rantien, Cramer,<br/>Kave (m), Zeuel, Pautz, Casper</i>                | <b>Rigging the Frammis...</b><br><i>Rothman, Cosakyan (m), Kessel,<br/>Bredenberg, Chalker, Panier</i>   |  |
| <b>G</b> | <b>Dr. Rubik Speaks for<br/>The Institute for<br/>Frontier Sciences</b>  | <b>The Dinosaur Society and<br/>the Real Dinosaurs</b><br><i>Dobson, Walters, Brett-Surman,<br/>Chapman, Deik, Soren</i>                         | <b>Reading</b><br><i>Michael Swanwick</i>  |
| <b>H</b> | <b>Amazing Graphics<br/>Stories</b><br><i>Manlev (m), Ling, McClellan,<br/>Parker, Schultz, Watkins, Wyman</i> | <b>The Cover Sells the<br/>Book</b><br><i>Bauman (m), Barnard, Eggleston,<br/>Morrissey, B. Vallejo, D. Vallejo</i>                              | <b>The Art of FX and<br/>Animation</b><br><i>Walters (m), Harryhausen,<br/>Kushwara, Saffren, Nakamura</i> |
| <b>I</b> |  | <b>Writers Workshop Manuscript Reading &amp; Critique</b><br><i>Schweitzer, Edelman, Moffet, Pollara, bes shahar, MacBride Allen</i>             |  |
| <b>J</b> |  | <b>Bubblegum Crash</b><br><i>episode 2: "Geo Climber"<br/>(subtitled)</i>  | <b>Earth vs.<br/>the Flying Saucers</b>  |
| <b>K</b> | <b>Autograph Signing</b>   | <b>Autograph Signing</b>   | <b>Autograph Signing</b>   |
| <b>L</b> | <b>Art Show open</b>   |  |  |
| <b>M</b> | <b>Babysitting open</b>  |  |  |
| <b>N</b> | <b>Con Suite open</b>  |  |  |
| <b>O</b> | <b>Dealers Room open</b>   |  |  |
| <b>P</b> | <b>Gaming open</b>   |  |  |
| <b>Q</b> | <b>Post Office open</b>  |  |  |

| <b>SATURDAY</b> |   |  |  |
|-----------------|---|--|--|
|                 | <b>3 PM</b>   | <b>4 PM</b>  | <b>5 PM</b>                                  |
| <b>D</b>        | <b>Boris Vallejo</b>  | <b>Greg Bear</b>   |  |
| <b>E</b>        |   |  |  |
| <b>F</b>        |   |  |  |
| <b>G</b>        | <b>The Search for the Missing Matter</b><br><i>Manov (m)</i>                                  | <b>Baubles Bangles and Beads</b><br><i>Mayberry (m), Dubé, Girdeau</i> | <b>Ask Auntie Esther</b><br><i>Fnesner</i>   |
| <b>H</b>        | <b>Speaking Forsoothly</b><br><i>Zebrowski (m), Fnesner, Gale, A. Hongsberg, Pannier, Ore</i> | <b>Mark Rodgers Paints</b>   | <b>Reading</b><br><i>Marvin Kaye</i>         |
| <b>I</b>        |   |  | <b>Reading</b><br><i>Judith Moffen</i>       |
| <b>J</b>        | <b>Earth vs. the Flying Saucers (continued)</b>   | <b>The Seventh Voyage of Sinbad</b>                                    |  |
| <b>K</b>        |   | <b>Autograph Signing</b><br><i>Boris Vallejo</i>                       | <b>Autograph Signing</b><br><i>Greg Bear</i> |
| <b>L</b>        | <b>Art Show open</b>  |  |  |
| <b>M</b>        | <b>Babysitting open</b>   |  |  |
| <b>N</b>        | <b>Con Suite open</b>   |  |  |
| <b>O</b>        | <b>Dealers Room open</b>  |  |  |
| <b>P</b>        | <b>Gaming open</b>  |  |  |
| <b>Q</b>        | <b>Post Office open</b>   |  |  |



**SATURDAY**

|                      | <b>SATURDAY 6 PM</b>  | <b>7 PM</b>   | <b>8 PM</b>  |
|----------------------|---|---|--|
| <b>A</b><br><b>B</b> |   |   |  |
| <b>C</b><br><b>D</b> |   |   |  |
| <b>E</b><br><b>F</b> |   |   |  |
| <b>G</b>             |   | <b>Masquerade Green Room</b><br><i>Masquerade participants only</i> |  |
| <b>H</b>             | <b>Movie &amp; Television Makeup</b><br><i>Kushwara</i>                                     |   | <b>Masquerade Photography</b><br><i>Masquerade participants only</i> |
| <b>I</b>             | <b>No Static: Courtesy &amp; Clarity in Live Recording</b><br><i>Hugel (m), C. Katakian</i> | <b>Reading</b><br><i>N Pollara</i>                                  | <b>Reading</b><br><i>J Morrow</i>                                    |
| <b>J</b>             | <b>Film</b>   | <b>Chronic Rift</b><br><i>featuring the SCA, The Prisoner</i>       | <b>Dead Again</b>  |
| <b>K</b>             |   |   |  |
| <b>L</b>             | <b>Art Show open</b>  |   |  |
| <b>M</b>             | <b>Babysitting open</b>   |   |  |
| <b>N</b>             | <b>Con Suite open</b>   |   |  |
| <b>O</b>             | <b>Dealers Room open</b>  |   |  |
| <b>P</b>             | <b>Gaming open</b>  |   |  |
| <b>Q</b>             | <b>Post Office closed</b>   |   |  |

| <b>SATURDAY</b>      |   |  |   |
|----------------------|---|--|---|
|                      | <b>SATURDAY 9 PM</b>  | <b>10 PM</b>                           | <b>11-3</b>                                       |
| <b>A</b><br><b>B</b> | <b>Masquerade</b>   |  |   |
| <b>C</b><br><b>D</b> | <div style="border: 1px solid black; padding: 5px; width: fit-content; margin: auto;"> <b>Filk Concert</b><br/> <i>Tom Smith performs during the Judging</i> </div> |  |   |
| <b>E</b><br><b>F</b> |   |  |   |
| <b>G</b>             | <b>Masquerade Green Room</b><br><i>Continued</i>  |  | <b>Filking</b>                                    |
| <b>H</b>             | <b>Masquerade Photography</b><br><i>Continued</i>   |  | <b>Filking</b>                                    |
| <b>I</b>             |   |  |   |
| <b>J</b>             | <b>Dead Again</b><br><i>(cont'd)</i>  | <b>Scanners</b><br><i>all Midnight</i> | <b>Heavy Metal</b><br><i>(starts at Midnight)</i> |
| <b>K</b>             |   |  |   |
| <b>L</b>             | <b>Art Show closed</b>  |  |   |
| <b>M</b>             | <b>Babysitting open (all Midnight)</b>  |  |   |
| <b>N</b>             | <b>Con Suite open</b>   |  |   |
| <b>O</b>             | <b>Dealers Room closed</b>  |  |   |
| <b>P</b>             | <b>Gaming open</b>  |  |   |
| <b>Q</b>             | <b>Post Office closed</b>   |  |   |

| <b>SUNDAY</b>        |  |  |   |
|----------------------|--|--|---|
|                      | <b>10 AM</b>   | <b>11 AM</b>   | <b>NOON</b>   |
| <b>A</b>             | <b>The Masquerade</b><br>How It Went and Why They Won  |  | <b>Jupiter, The Slide Show</b><br><i>Clement</i>        |
| <b>B</b>             | <b>SF in the Fortune-Teller's Tent</b><br><i>Cosulayan, Bredenberg (m), Zebrowski, MacBrule Allen, Andrews, Pes shahar</i> | <b>A Message from the Lost Valley of Fongo-Fongo</b><br><i>Clough, Lyon, Kruk (m), Kyle</i>          | <b>Reading</b><br><i>Zebrowski</i>                      |
| <b>C</b>             | <b>Ray Harryhausen Speaks</b>  |  |   |
| <b>D</b>             |  |  |   |
| <b>E</b><br><b>F</b> |  | <b>Bad Advice for Writers</b><br><i>Polkova, Swanwick (mj), Cosulayan, Crosson, Frost, Schweizer</i> | <b>Art Auction Setup</b><br><b>Auction Starts 12:30</b> |
| <b>I</b>             |  | <b>Reading</b><br><i>John Norman</i>   | <b>Reading</b><br><i>Marvin Kaye</i>                    |
| <b>J</b>             | <b>Bubblegum Crash</b><br>episode 3: "Meltdown"  | <b>Audience Request</b>  |   |
| <b>K</b>             |  |  |   |
| <b>L</b>             | <b>Art Show open (all 12.30)</b>   |  |   |
| <b>M</b>             | <b>Babysitting open</b>  |  |   |
| <b>N</b>             | <b>Con Suite open</b>  |  |   |
| <b>O</b>             | <b>Dealers Room open</b>   |  |   |
| <b>P</b>             | <b>Gaming open</b>   |  |   |
| <b>Q</b>             | <b>Post Office open</b>  |  |   |

| <b>SUNDAY</b>        |  |   |                           |
|----------------------|--|---|---------------------------|
|                      | <b>1 PM</b>  | <b>2 PM</b>   | <b>3 PM TILL...</b>       |
| <b>A</b>             | <b>Reading</b><br><i>Pamela Sargent</i>  | <b>Reading</b><br><i>Greg Bear</i>  |                           |
| <b>B</b>             | <b>Future Religions</b><br><i>S. Lichtenberg, Bear, Gale, Asher, Kondrauev (m), A. Honigsberg, Ore</i> | <b>A Dozen New Cosmologies</b><br><i>Beason (m), Von Gunden, Asher, Sivak, Kovari, MacBride Allen</i> |                           |
| <b>C</b>             | <b>Asimov Retrospective</b><br><i>Sathers (m), Dozsis, Zebrowski, Rohman, Williams</i>                 | <b>Significant Moments in Fan History</b><br><i>Chalker, Fleischmann, Kaize, Kyle, Wolkoff</i>        | <b>Gripe Session</b>      |
| <b>D</b>             |  |   |                           |
| <b>E</b><br><b>F</b> | <b>Art Auction</b><br><i>Continued</i>   | <b>ASFA Charity Auction to start at the end of the Art Auction</b>                                    |                           |
| <b>I</b>             |  |   |                           |
| <b>J</b>             | <b>Film room closed</b>  |   |                           |
| <b>K</b>             | <b>Autograph Signing</b><br><i>Rav Harryhausen</i>   | <b>Autograph Signing</b><br><i>George Zebrowski</i>   |                           |
| <b>L</b>             | <b>Art Show closed</b>   |   |                           |
| <b>M</b>             | <b>Babysitting open</b>  |   | <b>Babysitting closed</b> |
| <b>N</b>             | <b>Con Suite open</b>  |   |                           |
| <b>O</b>             | <b>Dealers Room open</b>   |   |                           |
| <b>P</b>             | <b>Gaming open</b>   |   |                           |
| <b>Q</b>             | <b>Post Office open (until 4 P.M.)</b>   |   |                           |

## Alphabetical Listing of Program Items

- A Dialog** A conversation between Greg Bear and Ray Harryhausen. to which we can listen. Sat Noon D
- A Dozen New Cosmologies Before Breakfast.** Science is getting increasingly far-out these days. Can science fiction keep up?  
Beason (m), Von Gunden, Asher, Strock, Kotani, MacBride Allen Sun 2PM B
- Alternate Art Markets.** Artists and collectors discuss opportunities for science fiction and fantasy artwork beyond the confines of publishing.  
Wyman (m), Koszowski, Dougherty, Menchan, Vartanoff, McClellan. Fri 6 PM H
- Amazing Graphic Stories.** Science Fiction and Fantasy in the graphic story, as seen by top comics artists.  
Manley (m), Lang, McClellan, Parker, Schultz, Watkins, Wyman. Sat Noon H
- Art of FX and Animation.** Detailed discussion of stop motion, computer cel animation, and prosthetic appliances.  
Walters (m), Harryhausen, Kushwara, Saffren, Nakamura. Sat 2PM H
- Arthurian Mythos from Geoffrey of Monmouth to the Modern Fantasy Novel.** After a millennium of retelling, the King Arthur story is as fresh as ever. Why?  
Kondratiev (m), Friesner, A. Honigsberg, bes shahar, Harris, Schroeck Sat 10AM E
- Ask Auntie Esther** Esther Friesner and friends. Sat 5 PM G
- Bad Advice for Writers.** From those who have received, and those in a position to give.  
Pollotta, Swanwick (m), Costikyan, Crosson, Frost, Schweitzer. Sun 11AM E, F
- Baubles, Bangles, and Beads.** Glitz, sequins, beads, and how they go on costumes.  
Mayberr (m), Dubé, Girardeau Sat 4PM G
- Bloodsucking Pharaohs in Pittsburgh.** Beverly Penberthy (Co-producer, Actress) and Jane Esther Hamilton (Actress) present a unique horror comedy filmed entirely in Pittsburgh! With your host, Marvin Kaye. Fri 10 PM J
- Bookaholics Anonymous Meeting.** Guilty pleasures and true confessions. Sister Kathy Logue saves souls, not to mention trees.  
Logue (m), Norton, Dashoff, bes shahar, Fontecchio, Bisenieks Fri 7PM F
- Boris Vallejo** describes his art and techniques. Sat 3PM D,E,F
- Bubblegum Crash I, II, III** — This the current evolution of the Bubblegum Crisis series, featuring new mecha, new villains, and an evolved society. The three parts that we are showing constitute a complete story line, and are also the only parts of the new series that exist. (Japanese with English subtitles)1; Sat 11 AM : 2; Sat 1PM : 3; Sun 10 AM All in room J



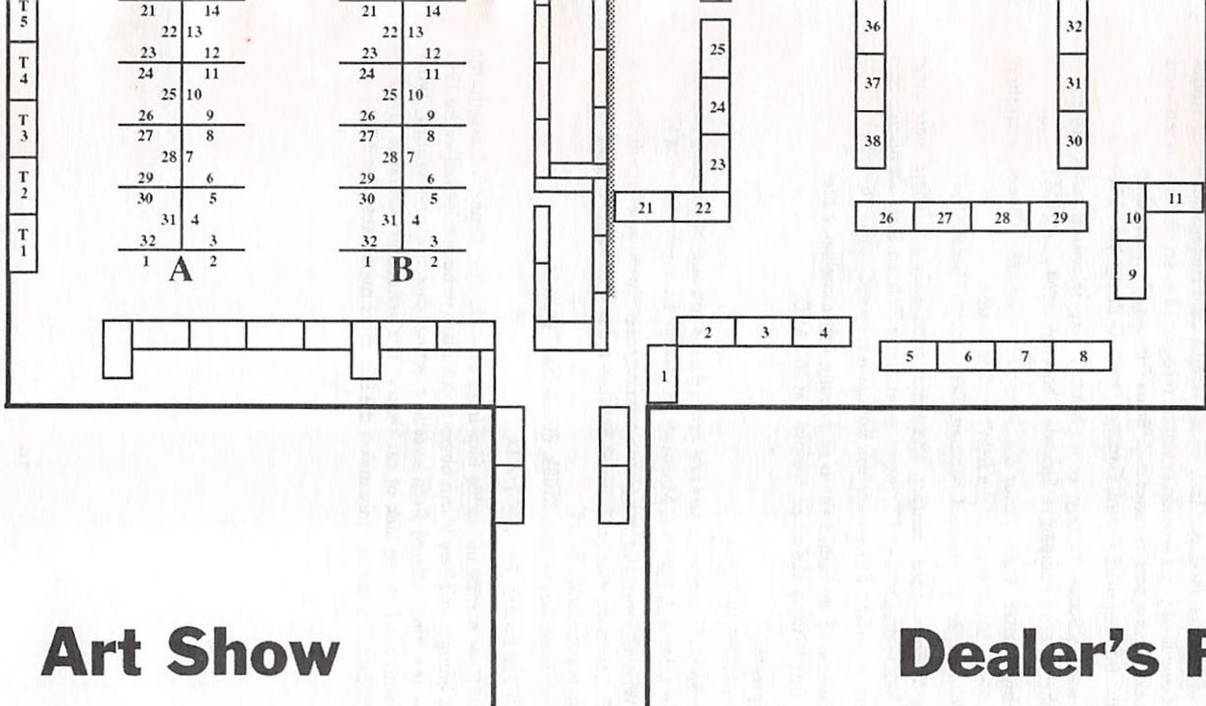

**Art Show**

**Dealer's Room**

**Bubblegum Crisis I** — Japanimation. This is the first in the series of eight features. Only part one will be shown this weekend, primarily so that we can introduce you to it. The story follows a band of mercenaries/vigilantes known as the Knight Sabers in their fight against the evil Genom corporation. The influence of Blade Runner cannot be overlooked in this film, not only are the Mega-Tokyo cityscapes recognizable as Deckard's L.A., but even the name of a character's band is Priss & the Replicants. (Japanese with English subtitles) Fri 9PM J

**Changing Face of Science Fiction.** Many of the leading (and Hugo-winning) SF stories of the past couple of years wouldn't even be recognized as science fiction ten years ago. No rockets, no robots, no science... "Bears Discover Fire," anyone? Bacon-Smith (m), Norman, Kotani, Garland, Drew, Doherty Sat 11AM F

**Chronic Rift.** A science fiction, fantasy, comic book. . . etc. television series carried by both Manhattan cable companies. Episodes shown Fri 6PM , Sat 7PM J

**Clarion Workshop Panel.** Learn about the fabulously successful Clarion workshop, which has produced so many of the field's leading writers. Dobson, Walters, Brett-Surman, Chapman, Deck, Sorten . Sat 9 AM I

**Classic Fantasy Writers:** Lord Dunsany and James Branch Cabell. There were great fantasists before the Deluge of Trilogies, even before Tolkien. Here we discuss two of the most important. Schweitzer (m), Kondratiev, Bear, Scithers Fri 8PM E

**Contact.** A discussion of the ramifications of meeting other intelligent life. Bear, Barr (m), Walters, K.Kofoed, Barlow. Sat 10 AM D

**Costume Headpieces.**  
Mayberry (m). Sat 10 AM G

**Cover Sells the Book.** Top cover artists talk about the ins and outs of the book business. Bauman (m), Barnard, Eggleton, Morrissey, B. Vallejo, D. Vallejo. Sat 1PM H

**Cult Authors.** Who do some writers become cult favorites? Cordwainer Smith, Philip K. Dick, H.P. Lovecraft, Marion Zimmer Bradley and a few others inspire devotion beyond mere popularity. Why? Cholfin (m), Kaye, Schweitzer, Krulik, Bisson Sat 11AM D

**Dance Party.** DJ Tim Binder. Fri 10:30 PM D

**Dead Again** (1991) — A truly incredible film from actor/director Kenneth Branagh, the man who brought us *Henry V*. An obvious candidate to be overlooked at the 1991 Oscars as the film suffered from excellent acting, directing and writing, while afflicted with a refreshing lack of car chases. The serious performance given by Robin Williams, in a cameo, only makes the film more memorable. Sat 8 PM J



**Dinosaur Society and the Real Dinosaurs.** What we know about the dinosaurs as opposed to the cute cartoon versions.

Dobson, Walters, Brett-Surman, Chapman, Deck, Sorten . Sat 1 PM G

**Earth vs. the Flying Saucers** (1956) — Ray Harryhausen produced the stop motion effects for this Fred Sear film. While the plot is not horribly original (*War of the Worlds* having been released in 1953), some of the special effect sequences are especially worthwhile. (No, of course I'm not referring to the saucer's crash into the Capitol Dome, and, of course, this is not a political statement on my part.) Sat 2 PM J

**Filking** is the music of and for Science Fiction fans. It includes songs about movies, books, fandom, characters, authors, and just about any other subject you can name, in styles ranging from parody to folk to rock and roll. Fri & Sat nights after 10PM in G & H

**Future Religions.** What Might People Believe in the Future? Discuss the future evolution of present-day creeds, and new religions that may emerge.

S. Litchenberg, Bear, Gale, Asher, Kondratiev (m), A. Honigsberg, Ore. Sun 1PM B

**Gaming.** Friendly games, games for making friends, intensely competitive games. Simple games and complex games. Games of the future, of history, of worlds fantastic. Games of intelligence and foolishness, of significance and trivia. Games for hours straight and people who like to get together over the gameboards. Really nice people, they are. Drop in. Say hello. P

**Greg Bear's** Guest of Honor Speech. Sat 4PM D,E,F

**Gripe Session** Come vent your spleen. Sun 3PM C, D

**Heavy Metal** (1981) — Ah, come on, if you don't know what this is, I ain't gonna tell ya. Come and revel in all its animated weirdness. The feature is comment friendly (like I have a choice?!\*@) Sat Midnight J

**Horror of It All.** Horror specialists discuss the field — trends in subject matter and imagery.

Bauman (m), Clarke, Eggleton, Koszowski, Lang. Fri 7 PM H

**How Fans Get Together.** Fandom evolved out of prozine letter columns and fanzines; then conventions became the major medium of communication; will computer nets be next?

Bushyager (m), Schwartz, Baltadonis, Axler, Bacon-Smith, Fleishmann Fri 7PM D

- I Wanna Be A Galactic Overlord When I Grow Up.** SF often fails to imagine future forms of government which are anything more than rehashes of the present — or the past. So, put our imaginations together. What might the future hold besides democracy, monarchy, military imperialism, theocracy, etc.? Are there some political constants through all space and time, such as, say, rule by the rich?  
Bear, Morrow, Gale, D. Honigsberg, Andrews (m), Lyon, Park, Ore. Sat 1PM D
- I'm Tired of Speaking Forsoothly:** Fantasy in Non-Medieval Settings. Explore other possibilities.  
Zebrowski (m), Friesner, Gale, A. Honigsberg, Painter Sat 3PM H
- Influence of Film on Writing.** Anybody born after 1920 or so grew up with movies. Anyone born after World War II grew up with television. How does this influence the way we write?  
Betancourt, Morrow, Harris (m), Weinstein, Krulik, Mist. Fri 8PM F
- Institute for Frontier Sciences.** The work of a local organization that investigates relevant phenomenon outside the mainstream of scientific theory.  
Rubik. Sat Noon G
- Introduction to Masquerading.**  
Warren (m) Fri 7PM G
- Is Horror Fiction Just Crime Fiction With More Sex and Gore?** If *The Silence of the Lambs* is the leading horror novel of the day, does this mean fantastic/supernatural horror is on the way out?  
van Gelder, Ranieri, Cramer, Kaye (m), Zettel, Pautz, Casper Sat Noon F
- Isaac Asimov Retrospective.** One of the seminal SF writers of the last fifty years recalled by friends and eminent colleagues.  
Scithers (m), Dozois, Zebrowski, Rothman, Williams Sun 1PM C,D
- It's What's Inside.** The almost lost art of interior illustration.  
Wyman (m), Koszowski, Dougherty, Menehan, Vartanoff, McClellan. Fri 7 PM H
- Jupiter Slide Show.** A slide show update on what's known about the king of planets.  
Clement. Sun Noon A
- Last Message-in-a-Bottle from the Hidden Valley of Fongo-Fongo:** Obsolete Literary Forms. If Edgar Rice Burroughs's Mars books and Rider Haggard's *She* are still popular, why is it no longer possible to write sword-and-planet or lost race novels? Can you think of any other fictional forms which may be headed for the same fate? Why?  
Clough, Lyon, Krulik (m), Kyle Sun 11AM B

- Legend of Hell House** (1973) — Author Richard Matheson crafted the screenplay from his own novel, *Hell House*. This is horror at its best. Not gory, not sick, just frightening, just like mom used to make. Fri 7 PM J
- Magazine Editors.** The field's leading editors discuss the state of the art (and business). Scithers, Williams (m), J. Betancourt, Strock, Dozois. Ryan, Edelman. Sat 10 AM I
- Mainstream SF and Fantasy.** When "outside" writers attempt SF, the results can be a naive re-invention of the wheel, or masterpieces far beyond anything to come out of the formal genre. (Witness *1984* or *Earth Abides*.) Zebrowski, Moffett, van Gelder (m), Lewitt, Troy-Castro, Frost, Ore. Sat 10 AM E
- Manuscript Critiquing.** New writers' stories, critiqued by professionals. Schweitzer, Edelman, Moffett, Pollotta, bes shahar, MacBride Allen. Sat 1 PM I
- Mark Rodgers Paints:** A Demonstration. The popular author-artist of *Samurai Cat* gives a demonstration of his craft.
- Masquerade.** Judges this year include George Paczolt, past Director and MC of our Masquerade, Doña Dube, Director of the Anisia Masquerade, and Boris Vallejo.
- Masquerade: How it Went and Why They Won.**  
A cast of thousands. Sun 10 AM A
- Meet the Pros.** Just what it says.  
Fri 9:30 PM D
- Movie & Television Makeup.** Find out how it's done.  
Kushwara. Sat 6 PM H
- Nanotechnology.** Tiny tools built an atom at a time, and the big results they yield.  
Andrews. Sat 11 AM G
- New Games.** These teach lessons other than those of mainstream sports.  
D. Honigsberg (m). Fri 6PM G
- No Static** Courtesy and clarity in live recording.  
Hagel (m), Kabakjian. Sat 6 PM I
- Nosferatu** (1922) — The F.W. Murnau classic silent film. Murnau released this film as his own original story. Bram Stoker's widow viewed it and sued. The movie was pulled from distribution, and most copies were destroyed. Despite this, it still remains a horror classic. (German subtitles with English subtitles....No....Really....I mean it!) Fri 12:30 \*M (Sat 12:30 AM) J
- Pamela Sargent** speaks at the Philadelphia Science Fiction Society meeting. Her topic: "Writers, Science Fiction, and Family Values." Fri 8PM D

- Phase IV** (1974) — Ants. We needed a monster film, but we're on a tight budget. So I got a lot of small monsters. Actually, the film is a unique blend of horror and science fiction, with excellent cinematography. Sat 8 AM J
- PSFS Meeting.** Pamela Sargent speaks at the monthly meeting of the Philadelphia Science Fiction Society. Fri 8PM D
- Planning Filk for Your Convention.**  
Hagel (m), S. Love. Fri 9PM G
- Post Office** A special Philcon cancellation, available both Saturday and Sunday, created by Bob Walters.
- Ray Harryhausen** presents an hour of special effects magic on Sunday. Sun 10AM C,D
- Readings** Our guests, live. See the Grid for list of authors .
- Rigging the Framis to the Fungleworp Generator.** How much of the science in SF is doubletalk? How much has to be? Is it possible to play entirely straight with the reader and still have a science-fiction story? Zebrowski, Moffett, van Gelder (m), Lewitt, Troy-Castri, Frost Sat 1PM F
- Scanners** (1981) — Violence, car chases, exploding heads — it makes me proud to be an American! (insert "The Star Spangled Banner" here) David Cronenberg's tale of warring groups of psychics is as odd as it is entertaining. Also, Patrick McGoohan (*The Prisoner, Secret Agent Man*) gives a good performance. Sat 10 PM J
- Search for Missing Matter.** An astrophysicist discusses his searches for the dark matter that may make up much of the Universe.  
Martov (m) Sat 3 PM G
- Self Promotion for the Writer or Artist.** What you should — or should not — do to further your career.  
Clough, Sargent, Van Vlack, J. Betancourt (m), Pollotta, Tan. Sat 10 AM I
- Seventh Voyage of Sinbad** (1958) — What can I say? This is one of Ray Harryhausen's pieces of stop motion magic. The combination of Charles Schneer production, Nathan Juran direction, and the writing of Kenneth Kolb helped make this a truly enjoyable film that has stood the test of time. Sat 4 PM J
- SF in the Fortuneteller's Tent.** We're always saying, "No, science fiction isn't really about prediction." Well, some of it (psst! secret!) really is. A panel of prognostically-inclined SF writers actually attempt to predict the next few hundred years — before your very eyes!  
Costikyan, Bredenberg (m), Zebrowski, Andrews, MacBride Allen, bes shahar. Sun 10 AM B
- Significant Moments in Fan History.** Hear about us at our best and our worst.

Chalker, Fleischmann, Katze, Kyle, Wolkoff. Sun 2 PM AM C, D

**Slide Show.** . . Fandom's personalities captured.

Klein (m) Sat 9 AM F

**So Goldfish Don't Have the Vote:** Politically Correct in 2400. Something about the society and literature of the 20th century will inevitably be unacceptable in the future, even as the norms and givens of the past aren't quite as "obvious" as they once were. What do we take for granted that will appall our descendants?

Andrews, Norman, Sargent, Friesner, Cramer, MacBride Allen, Kagan, Chase, Ore. Fri 9 PM F

**Speaker-to-Aliens: Interspecies Communication.** Earth people have enough trouble talking to one another? How will we do it when the other guy speaks with scents and sees in the ultra-violet?

Axler, Beason, Von Gunden, Asher (m), Kagan, Gilliland. Sat 11 AM E

**Suppose Queen Isabella HAD Said No?** Fear of science, the loss of nerve . . . what does it mean if we stop exploring?

Axler, Beason, Von Gunden, Asher (m), Kagan, Gilliland. Sat Noon E

**3-D Science Fiction and Fantasy Art.** Artists discuss materials and techniques used in 3-D SF art and their subjects and themes.

K. Kofoed (m), Frechette, Sorten, Harryhausen, Kushwara. Sat 10 AM H

**Tom Smith** performs during the intermission at the Masquerade. Sat Appx. 10PM A,B,C,D,E,F#

**When Dinosaurs Ruled the Arts.** Artists discuss dinosaur imagery in science fiction art and film.

Walters (m), Brett-Surman, Chapman, Harryhausen, Schultz, Sorten. Sat 11 AM H

**Women and Fantasy.** Two or three generations ago, virtually all the fantasy writers were men (Tolkien, Dunsany, Cabell, Peake, T. H. White etc.). Today virtually all of them seem to be women. Why? Is this perception accurate?

Costikyan, Van Vlack, Cramer, Honigsberg (m), Holman, bes shahar, Hartwell, Buggé. Fri 7 PM E

**Worst Foot Forward.** Robert Bloch coined this term to describe the worst of science fiction which the general public thinks to be science fiction. For instance, mainstream readers think *Jurassic Park* a revelation...science fiction fans aren't very impressed. It could be worse. Back when Bloch was writing, the public thought SF was big bugs. Have we made any progress? Sargent (m), Asher, DeChancie, Frost, Harris, Kotani, Moffett, Pollata, bes shahar, Anderson, Chalker. Sat 1 PM E

## GUESTS OF PHILCON '92

|                         |                          |                         |
|-------------------------|--------------------------|-------------------------|
| Roger MacBride Allen    | Scott Edelman            | Wendy Lang              |
| James W. Anderson III   | Bob Eggleton             | Alex Latzko             |
| Arlan Andrews           | Stephen Fisher           | S. N. (Shariann) Lewitt |
| Ellen Asher             | Esther Friesner          | Solomon Lichtenberg     |
| David Axler             | Gregory Frost            | Kathy Logue             |
| Camille Bacon-Smith     | Ken Gale                 | Richard Lyons           |
| Greg Barr               | Mark Garland             | Bob Madle               |
| Wayne Barlowe           | Bobby Gear               | Mike Manley             |
| Bryn Barnard            | Alexis Gilliland         | C.J. Martor             |
| Jill Bauman             | Denise Girardeau         | Elizabeth Mayberry      |
| Greg Bear               | Kurt Griffith            | Aaron McClellan         |
| Doug Beason             | Jane Esther Hamilton     | Charles G. McGraw       |
| eluki bes shahar        | David Harris             | David Menehan           |
| John Gregory Betancourt | Ellen Key Harns          | Myrrh Mist              |
| Michael Betancourt      | Ray Harryhausen          | Pat Morrissey           |
| Dainis Bisenieks        | David Hartwell           | James Morrow            |
| Terry Bisson            | Robert Himmelsbach       | John Norman             |
| N. Taylor Blanchard     | Mike Hinge               | Janis O' Connor         |
| Jeff Bredenberg         | Judith Holman            | Rebecca Brown Ore       |
| Will Brown              | Alexandra Honigsberg     | George Paczolt          |
| Carol Buggé             | David Honigsberg         | Mark Painter, Sr.       |
| Linda Bushyager         | Nicholas Jainschigg      | Charley Parker          |
| Susan Casper            | Janet Kagan              | Beverly Penberthy       |
| Jack Chalker            | Rick Katze               | Roman Ranieri           |
| Robert C. Chase         | Marvin Kaye              | Paul Park               |
| Bryan Cholfin           | John Kessel              | Peter Pautz             |
| Alan M. Clark           | Tom Kidd                 | Nick Pollotta           |
| Hal Clement             | Janet Kofoed             | Mark Rodgers            |
| Brenda Clough           | Karl Kofoed              | Milton Rothman          |
| Greg Costikyan          | Yoji Kondo (Eric Kotani) | Dr. Rubik               |
| Kathryn Cramer          | Alexei Kondratiev        | Charles Ryan            |
| Lynn Crosson            | Allen Koszowski          | Harry Saffren           |
| John DeChancie          | Aimee Kratts             | Ian Randall Strock      |
| Peter Dodson            | Ted Krulik               | Pamela Sargent          |
| Tom Doherty             | Jay Kushwara             | Felicity Savage         |
| Charles Dougherty       | David Kyle               | Bob Schroeck            |
| Gardner Dozois          | Lissanne Lake            | Mark Schultz            |
| Doña Dube               | Charles Lang             | Julius Schwartz         |

Darrell Schweitzer  
George Scithers  
Cynthia Seelhammer  
Tom Smith  
Paul Sorten  
Tim Standish  
Michael Swanwick  
Cecilia Tam

Adam Troy-Castro  
Boris Vallejo  
Dorian Vallejo  
Mercy Van Vlack  
Kenneth Von Gunden  
Bob Walters  
Victoria Warren  
Diane Weinstein

Lew Wolkoff  
Sheila Williams  
V. M. Wyman  
George Zebrowski  
Cynthia Zender  
Sarah Zettel

Philcon would like to thank all the folks at Animeigo for letting us show the Bubblegum features. (No, really, we didn't have to say it — we wanted to say it! [No! Really! I actually did buy these videotapes!])

Special thanks to Kirk Pennak at Films, Inc. for all his more-than-valuable assistance.

## Key to Restaurant Guide

**Distance** is in approximate blocks from the hotel.

**Speed** is speed of service: fast, brlsk, medium, leisurely, slow.

**Price** is approximately: Low under \$6.00 per person

Medium \$6.00-\$16.00 per person

High over \$16.00 per person

+ In distance column means off the map

M on map is a Mac (Instant cash) machine

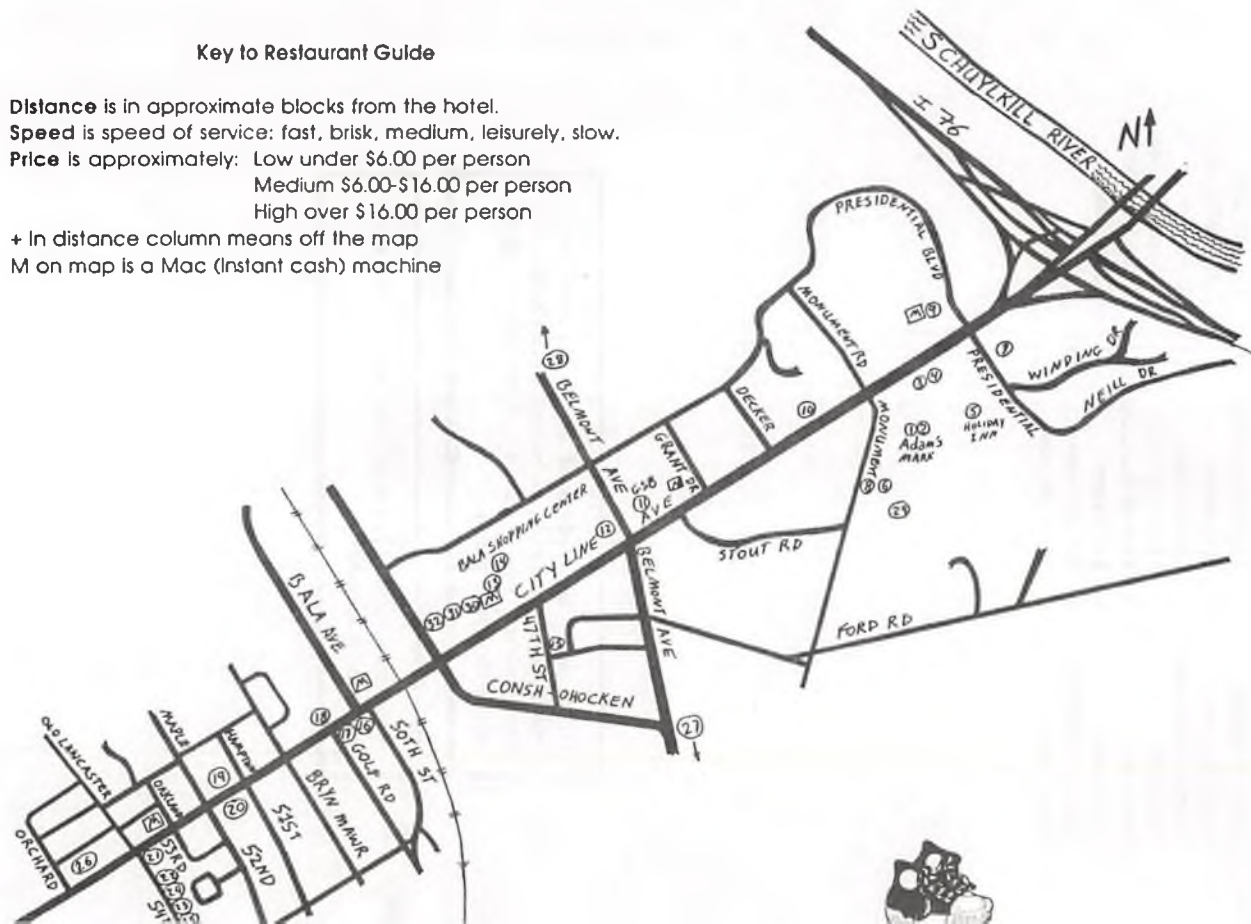



# RESTAURANT GUIDE

|    | Name                  | Address            | Phone    | Cuisine     | Dist | Speed | Price | Friday      | Saturday     | Sunday      | Opinion & Notes         |
|----|-----------------------|--------------------|----------|-------------|------|-------|-------|-------------|--------------|-------------|-------------------------|
| 1  | Applebys              | In hotel           | 581-5000 | American    | 0    | leis. | med   | 6:30a-11p   | 6:30a-11p    | 6:30a-11p   |                         |
| 2  | The Marker            | In hotel           | 581-5000 | French      | 0    | slow  | high  | 6p-10:30p   | 6p-10:30p    | 6p-10:30p   | Sun brunch 1030a-2p     |
| 3  | Denny's               | 4020 City Line     | 473-9260 | American    | 1    | leis  | med   | 24 hours    | 24 hours     | 24 hours    |                         |
| 4  | TGI Fridays           | 4000 City Line     | 878-7070 | American    | 1    | med   | med   | 11a-1a      | 11a-1a       | 11a-1a      | Sun brunch 11a-2p       |
| 5  | The Glass Tree        | 4100 Presidential  | 477-0200 | American    | 1    | med   | med   | 6:30a-10p   | 7a-10p       | 7a-10p      |                         |
| 6  | Chung Hing            | 4160 Monument      | 879-6270 | Chinese     | 2    | med   | med   | 11:30a-11p  | noon-11p     | 3p-9:30p    | Crowded                 |
| 7  | El Torito             | 3900 City Line     | 878-9434 | Mexican     | 2    | med   | med   | 11a-mid     | 11a-mid      | 10:30a-11p  | Similar to ChiChis      |
| 8  | Allegro Pizza         | 4160 Monument      | 879-6964 | Pizza       | 2    | brisk | low   | 11a-11p     | 10a-mid      | noon-10p    | Delivers!               |
| 9  | Chatley's Place       | 555 City Line      | 667-9717 | American    | 3    | slow  | med   | 11:30a-mid  | 11:30a-mid   | 9:30a-9:30p | Sun brunch 'til 2:30p   |
| 10 | Kyoto Sushi           | 2 Bala Cynwyd Pl   | 667-7773 | Japanese    | 4    | leis. | high  | 530p-1030p  | 5:30p-10:30p | 5p-9P       | Behind Saks             |
| 11 | Williamson's Rest.    | CSB Bldg/City Line | 839-7946 | American    | 7    | leis. | high  | 12-2/5p-9p  | 12-2/5-9     | Closed      | 12th fl/jacket required |
| 12 | Chilis                | 175 E. City Line   | 667-4444 | Texas       | 8    | brisk | med   | 11a-mid     | 11a-mid      | 11a-11p     | Popular chain           |
| 13 | Hillary's Ice Cream   | Bala Shop. Center  | 667-9068 | Ice cream   | 10   | fast  | low   | 11a-10p     | 11a-10p      | 1p-10p      | Expensive but good      |
| 14 | Vegetarian Rest.      | Bala Shop. Center  | 664-5231 | Vegetarian  | 10   | brisk | low   | 11a-3p      | 11a-3p       | Closed      | No chicken or fish      |
| 15 | City Line Pizza       | 2749 North 47th    | 477-1535 | Pizza       | 11   | brisk | low   | 11a-mid     | 11a-mid      | 4p-10p      | Delivers!               |
| 16 | Imperial Gourmet      | 5000 City Line     | 473-7147 | Chinese     | 14   | med   | med   | 11a-11p     | noon-11p     | 3p-10p      | Delivers!               |
| 17 | Hardees               | 5020 City Line     | 879-1888 | Burgers     | 14   | fast  | low   | 6a-mid      | 6a-mid       | 7a-mid      | Formerly Roy Rodgers    |
| 18 | San Marco Rest.       | 27 City Line       | 664-7844 | Italian     | 14   | leis. | high  | 2p-10p      | 2p-10p       | Closed      | Lunch 11:45a-2:30p      |
| 19 | Int'l House/Pancakes  | 115 W City Line    | 668-9860 | American    | 17   | brisk | med   | 6a-3a       | 6a-3a        | 6a-mid      | No checks or plastic    |
| 20 | Dunkin Donuts         | 5100 City Line     | 878-3222 | Donuts      | 17   | fast  | low   | 24 hours    | 24 hours     | 24 hours    | Has drive-through       |
| 21 | Popeye's Chicken      | 5323 City Line     | 879-3575 | Chicken     | 20   | fast  | low   | 10:30a-mid  | 10:30a-mid   | 10:30a-11p  |                         |
| 22 | Peking Palace         | 2469 North 54th    | 879-1177 | Chinese     | 21   | brisk | med   | noon-11:30p | 2p-11:30p    | 2p-10:30p   |                         |
| 23 | City Line Grill & Bev | 2471 North 54th    | 879-8620 | American    | 21   | brisk | low   | 7a-11p      | 8a-1a        | 10a-mid     | store open 1 hr longer  |
| 24 | Dominos               | 2451 North 54th    | 878-0030 | Pizza       | 21   | brisk | low   | 11a-2a      | 11a-2a       | 11a-1a      | Delivers! No seating    |
| 25 | Larry's Steak         | 2457 North 54th    | 879-1776 | American    | 21   | brisk | low   | 11a-3a      | 11a-3a       | noon-11p    |                         |
| 26 | Wendy's               | 77 City Line       | 473-6040 | Burgers     | 22   | fast  | low   | 10a-11p     | 10a-11p      | 10a-10p     |                         |
| 27 | One Crazy Greek       | 1999-1/2 N 52nd    | 477-5588 | Greek/Pizza | +    | brisk | low   | 11a-2a      | 11a-2a       | noon-mid    | Delivers!               |
| 28 | Mama's Pizzeria       | 426 Belmont Ave    | 664-4757 | Pizza       | +    | brisk | low   | 11a-9P      | 11a-9p       | Closed      | Delivers!               |
| 29 | Pathmark              | 4160 Monument      | 879-1292 | Grocery     | 2    | med   | —     | 24 hours    | 24 hours     | 24 hours    | Grocery Store           |
| 30 | Thrift Drug           | Bala Shop. Center  | 664-7300 | Pharmacy    | 10   | med   | —     | 9a-9P       | 9a-9P        | 10a-3p      | Pharmacy                |
| 31 | Acme                  | Bala Shop. Center  | 667-8509 | Grocery     | 11   | slow  | —     | 6a-1a       | 6a-1a        | 6a-10p      | Grocery Store           |
| 32 | A+ Mini Mart          | Bala Shop. Center  | 667-6958 | Grocery     | 12   | fast  | —     | 24 hours    | 24 hours     | 24 hours    | Convenience Store       |

## ART SHOW LISTING

### SECTION A:

- 1-2 M Hinge  
 3-5 J Van Hollander  
 6-8 Ric Frame  
 9-11 W Mitchell  
 12 L Perkins  
 13-14 A Koszowski  
 15-16 K Kofoid  
 17 A&LB Washington  
 18 D&B Atwood  
 19-20 R&L Ashton  
 21-22 W Zummerman  
 23 Isk Alexander  
 24 I Revelas Jr  
 25 S Mandelbaum  
 26 B Bruhn  
 27 C Willrich  
 28 M Brahen, R Smith  
 29 S Santara  
 30 HMG Shapero  
 31 L Paskman-Syms, BL Higgins  
 32 M Rutkowski, Ankel Scheppner

### SECTION B:

- 1-2 ASFA Charity  
 3-8 B. Vallejo  
 9-11 Julie Belle  
 12-14 D Vallejo  
 15-17 R Harryhausen or P. Peebles, D. Wilson  
 18-20 N T Blanchard  
 21-23 Alan Clark  
 24-26 L Lake  
 27-29 B Walters  
 30-32 J Bauman

### SECTION C:

- 1 F Haas  
 2-3 N Jainschigg  
 4-6 J Adams  
 7 C Mylynnne  
 8-9 G Lippincott  
 10-12 J Holman  
 13-14 S Fox  
 16 M Livingston  
 17-18 R Santinha  
 19 D H Stein  
 20-21 H Bruton  
 22-23 G Frechette  
 24 P Malone  
 25 I Abra Cini, B Selletti  
 26 B Selletti, M Stay McDonald  
 27 L St Romain  
 28 J Bellafatto  
 29 D Satter  
 30 P Ritter  
 31 T Truelove  
 32 P Munson-Siter  
 33-34 N Janda  
 35 J Clouse  
 36-37 N Halpern, E Varnoff  
 38 C Sudano

- 39 F Jacquette  
 40 J Cometto, M Mozello  
 41 PC Butler  
 42 A Fisk  
 43-44 K Lufkin

### SECTION D:

- 1-3 B Eggleton  
 4-6 P Morrissey  
 7-9 W Brown  
 10-12 D Menehan  
 13-15 B Barnard  
 16-17 Wendy Lang  
 18 Charles Lang  
 19-21 Mark Rodgers, Tim Standish  
 22 Burns/Hescox  
 23 Jael, Ruddell  
 24-26 M Van Vlack, K Gnifith  
 27 S VanCamp  
 28-29 L Schwinger  
 30 R Morris

### SECTION E:

- 1-10 Print Shop  
 11-13 T Wright, L Sunk, K Poor, T Kidd  
 14-16 J Lee, F Kelly Freas, M Ferrai, M Bates  
 17-19 R Spangler, D Cherry, E Mitchell  
 20-22 J Platts, I Neilson, B Hobbs  
 23-25 P Davis, R Musgrave, M S Dollens, J A Roller

### TABLES:

- 1 M Rutkowski, B L Higgins, L Paskman-Syms  
 2 N Lilly  
 3-4 H Love  
 5 Ashton  
 6 Atwood  
 7 J Prenis  
 8 P Campbell, Lyon  
 9 K Luifken  
 10 F Jacquette  
 11 N Halpern, C Sudano  
 12-13 K J Weiss, N Janda  
 14 D A Lypscomb  
 15 M Stacy McDonald  
 16 B Selletti  
 17 TBA  
 18 D Dubé  
 19 P Malone  
 20 P Sorten  
 21-22 E Edmunster  
 23 M Burner, C Moore  
 24 M Van Vlack  
 25 J Mayhew, J Roller

## DEALERS' ROOM LISTING

- 1 Sense Of Wonder Books  
*Rebecca Kaplowitz*  
 2 A.G.H.I.T.W. Bookstore  
*Ira Kaplowitz*  
 3-4 Science Fiction Continuum  
*Su Bravak*  
 5-6 Reclining Dragon  
*Kelie & Randolph Gallagher*  
 7-8 Fo' Paws Productions  
*Jane & Scott Dennis*  
 9-11 Angelcrafts & Sandscrafter  
*Kathy Kasprzik & Larry Sands*  
 12-14 Showcase Comics  
*Michael Clark*  
 15-17 Tales From the White Hart  
*Kathy & Leo Sands*  
 18-20 Jenkintown Hobby Center  
*Robert Frantz*  
 21 P.S.F.S. Sales Table  
*John Prems*  
 22-23 The Wildside Press  
*John & Kym Betancourt*  
 24-25 Sieve Dolnick  
 26 Discovery Toys  
*Rene Bate*  
 27 Aboriginal SF  
 28 Andrew Andrews  
 29 Terra Incognita  
*Elan Jane Litt*  
 30 TBA  
 31 Wail Songs  
*Bob Laurent*  
 32-33 Bump In the Night Books  
*Sanford Jablow*  
 34 Thorney Rose Designs  
*Lyn Larnshaw*  
 35-36 White Light Unlimited  
*Tina Anne Carl*  
 37 Deb Smith  
 38 Evolution Comics  
*Ken Gale, Mercy Van Vlack*  
 39-40 Michael Walsh  
 41 Bizarre  
*Robert Belgrad*  
 42-44 Space Station Studios  
*William Rudow*  
 45 Futherance  
*Raymond Rooney*  
 46 Fantasy Shirts  
*Roger Smith*  
 47-49 Collectors Den  
*Dennis Noron*  
 50-52 J-J Books  
*Jack Gonzales*  
 53-54 Nancy Lebovitz  
 55 Weird Tales  
*Darrell Schwenz*  
 56-57 Jerry Ohlinger's Movie Material Store Inc.  
*Mike Wooden*  
 58 Janet Kofoid  
 59 Other World B.  
*Roberta Rogan*  
 60-61 White Witch Miniatures  
*Pai Campbell*  
 62 R.P.&S. Society Guild  
*Barbara Sellett*  
 63 The Wizards D  
*Carmen Castelle Schofield & Mar Drexler*  
 64-65 Robert J Whitake  
 66 Honeck Sculpture  
*Butch Honeck*  
 67 Luna Enterprise  
*Frank Dentz*  
 68 Sherman Fantasy Books  
*Allan Sherman*  
 69 Juniper Forge  
*Walter Gaisley*  
 70 Science Fiction Chronicle  
*Andrew Porter*  
 71-72 Tigereyes Book  
*Chris Logan Eda*  
 73-74 Arabian Nights  
*Ford & Wendy C*  
 75-77 Troll Video & T  
*Jon Huston*  
 78-79 GSB dba Drago Hoard  
*Mitchell Botwin*  
 80 Alexi & Cory Pa  
 81 DynaComm  
*Rav Ferry*  
 82-84 Laurence C. Sm Bookseller  
 85 Dancing Wolf Studio  
*Sandra Sun Tar.*  
 86-87 Davis Books  
*Kevin Davis*

Did You Miss  
**BEAR'S FANTASIES**

The 1992 Philcon Book by

**GREG BEAR . . . ?**

It's available after Philcon 92 for \$30.00 per copy for the hardcover (limited to 200 signed, numbered copies) and \$10.00 per copy for the trade paperback. Include \$2.50 for the first copy, 50 cents for each additional copy, for postage and handling. Order from/checks payable to:

The Wildside Press  
37 Fillmore Street  
Newark, NJ 07105

This program was produced during the course of many late hours in the wee the morning by the Philcon Publications staff, especially Tim Binder (above beyond the call of duty), Dave Szent-Gyorgyi (no sleep, no food, just the book & John Syms (from Mac-ignorant to Mac-literate in one, *easy(!!!)* lesson). All typos, errors, glaring omissions or commissions are strictly the fault of last minute changes occurring after this booklet's production. (Either that or those gremlins we heard scampering around at 2 AM. I knew we shouldn't have left that fool out at that hour!)